

Pos.-Nr.	Zeichnung Nr.	Benennung	Material	Revision	Menge
1	13-01-14-1804-01	Pinaufnahme	1.4021	B	1
2	13-01-14-1804-02	Griff	1.4021	B	1
3	69-40-01-1602	Schraube	1.4305	A	1
4	69-43-09-1602	Feder	1.4310	A	1
5	Stift_2x6mm	Stift 2 mm	1.4441	A	1
6	Stift_2,5x10mm	Stift 2,5 mm	1.4441	A	1

Stift $\varnothing 3,5 \sqrt{20}$

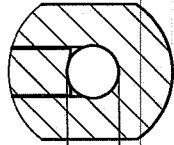

DETAIL C
MABSTAB 2:1

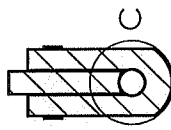

ANSICHT A-A

Laser
anschließend verebnet

$1,2 \pm 0,2$

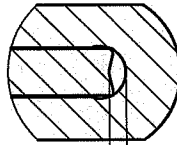

DETAIL D
MABSTAB 2:1

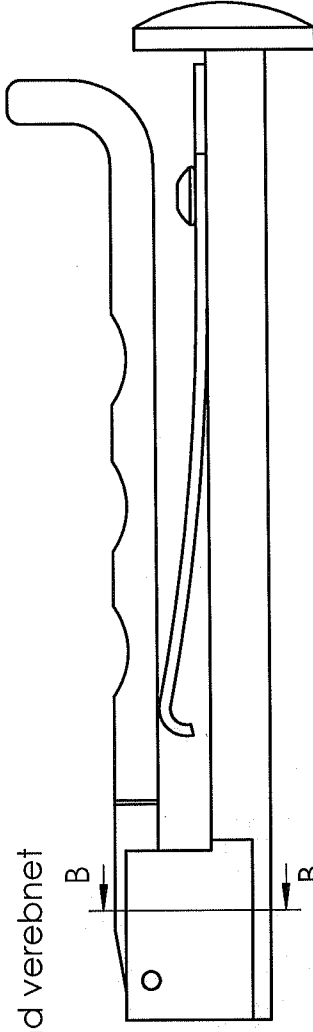
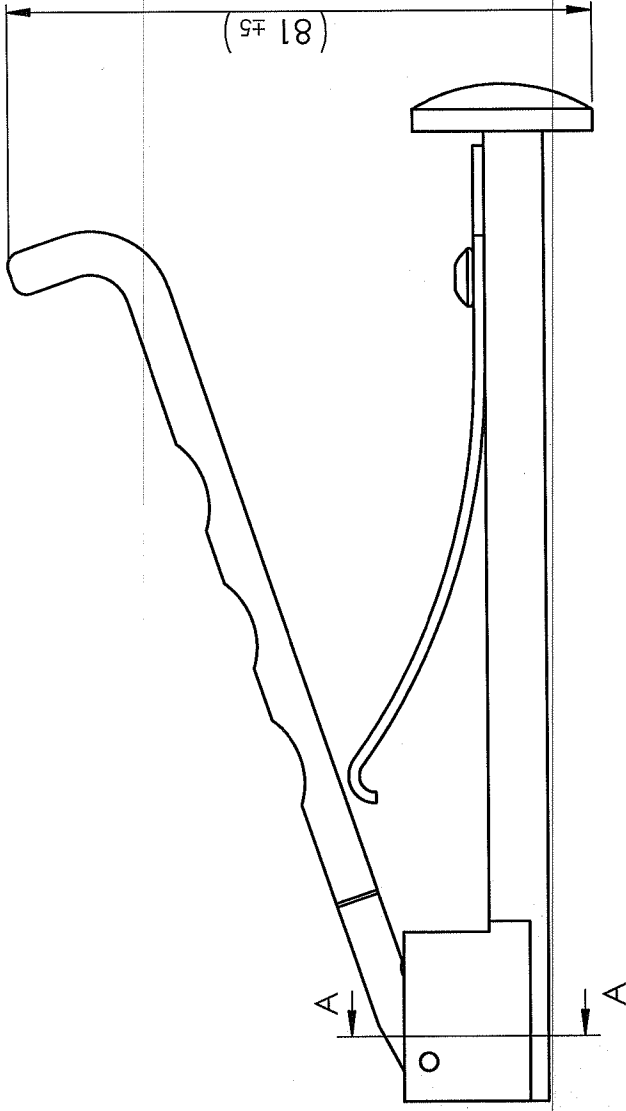

ANSICHT B-B

Toleranzen (mm) DIN ISO 2768m		Maßstab 1:1 (Werkstoff, Halbzeug, Rohteil-Mockteil-Gesenk-Nr.)		Revision B	
bis 6	6-30	30-120	120-400	400-1000	
$\pm 0,1$	$\pm 0,2$	$\pm 0,3$	$\pm 0,5$	$\pm 0,8$	
		DIN 611 Proj.methode 1		Benennung	
		DATUM		Universal Pin Puller für $\varnothing 1,5-3,5$ mm	
		NAME		ZEICHNUNGSNR.	
		Erst. 22.03.2017		13-01-14-1804	
		Gep. 22.03.2017		1 VON 1	
		Freig. 22.03.2017			
		E. Schilling			
		SMT Schilling			
		Metalltechnik GmbH			

NON DISCLOSURE AGREEMENT
This drawing and / or specification contains information confidential and proprietary to SMT Schilling Metalltechnik GmbH Germany; and is conditionally loaned only. By retention, the receipt agrees not to reproduce or copy it in whole or in part, disclose any or all of its contents without prior written permission, or to make any use of it contrary to SMT Schilling Metalltechnik interest. SMT - Werkzeichnung; entspricht nicht nach DIN